

HSF

Recommended P.C.B Layout (Top Side)
(PCB BOARD TOLERANCE ±0.05)

NOTES:
 Rated Current: 7.0AMP.
 Contact Resistance: 20mΩ Max.
 Withstand Voltage: 1000V AC/DC
 Insulation Resistance: 1000MΩ Min.
 Operation Temperature: -40°C to +105°C

Contact Material: Brass
 Contact Plating: Au or Sn Over Ni
 Insulator Material: LCP+30%G.F UL94V-0 BK(Std)
 or PA9T+33%G.F UL94V-0 BK

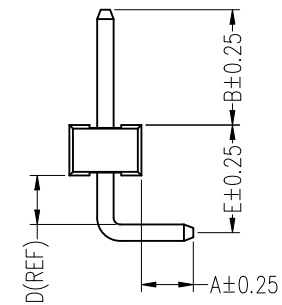
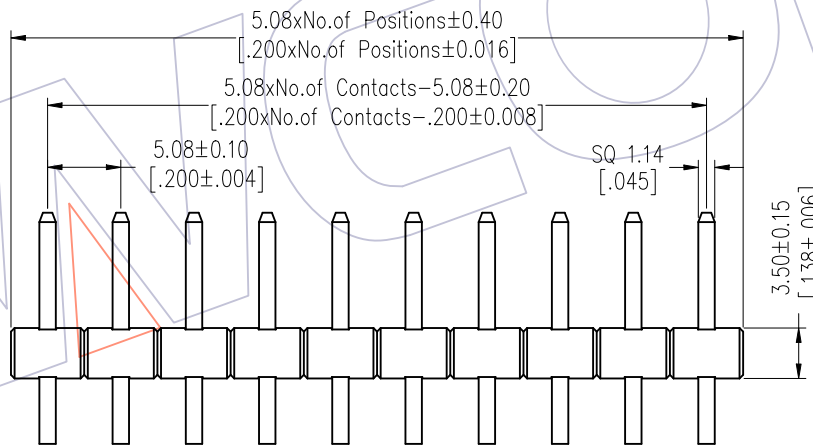
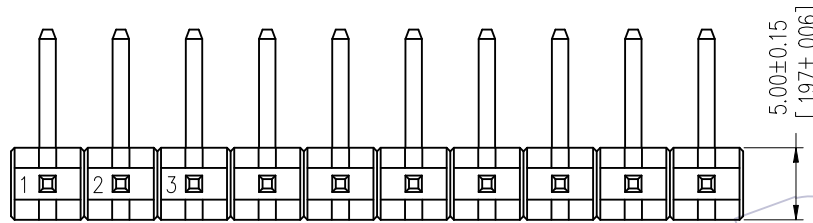
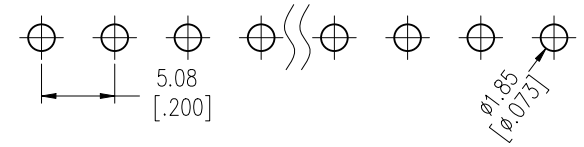

Ordering Information

1935-11 XX XX R XXX X 0 XX

No. of Pins	Contact Plating	Pin Length	Insulator	Packing	Series No.
01~20	G0=Gold Flash	L=A+B+D+6.0	C=PA9T	0=PE Bag	01~99
	SN=Tin	Std:210=21.0	D=LCP		
	SM=Matte Tin				

Item	Pin Length	A	E	B	Mating
Standard	21.0	3.60	7.47	8.00	2989
Alternate					

REV	DATE	MODIFICATION DESCRIPTION	CHANGE	OPERATION	DRAW	DATE	SCALE	Fit	PART NO.
				X.X ±0.40	William Chen	2018/01/26	UNIT	mm [inch]	1935-11XXXXRXXXXXX
A1	2018/01/26	MODIFY PART NO.	-----	X.XX ±0.25	CHECK	DATE	SIZE	A4	TITLE:
A0	2012/07/06	NEW	-----	X.XXX ±0.15	APPROVE	DATE	SHEET	1/1	5.08 Pin Header, SINGLE ROW, R/A, H=3.5
				Angle ± 3°			PROJ.		Customer NO.
				DIM TOL					

WCON
 Http: www.wcon.com
 WCON-Dongguan Tel: +86 769 85358920
 WCON-Kunshan Tel: +86 512 57468408
 Fax: +86 769 85358915
 Fax: +86 512 57468468
 E-mail: sales@wcon.com
 E-mail: salesks@wcon.com